

ROBO-MAX™

T-REX



AGES 7+
ADULT ASSISTANCE RECOMMENDED

RIGHT LEG

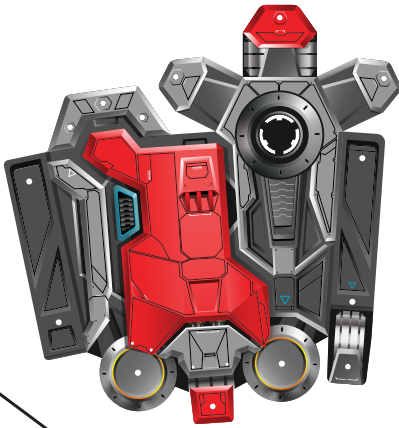

Upper Leg



Hinge Spacer (Leg)

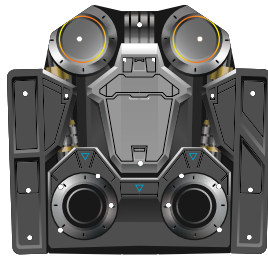

Lower Leg

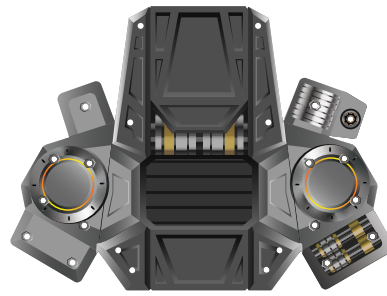

Foot

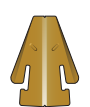

Short Claw



Long Claw



Short Claw



Foot Cover Front



Foot Cover Back

LEFT LEG

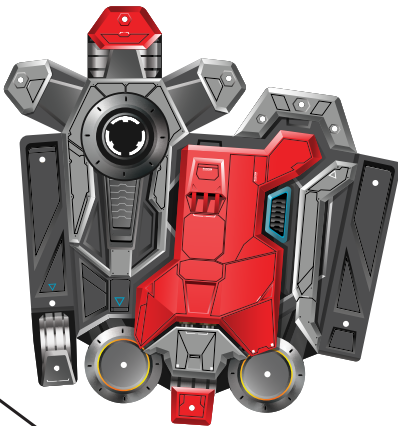

Upper Leg



Hinge Spacer (Leg)

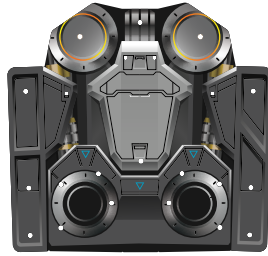

Lower Leg

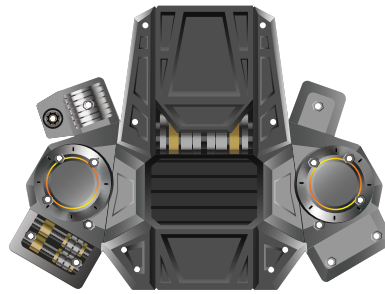

Foot

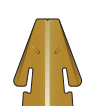

Short Claw



Long Claw



Short Claw



Foot Cover Front



Foot Cover Back

BODY



Body Top Cover



Body Structure #2

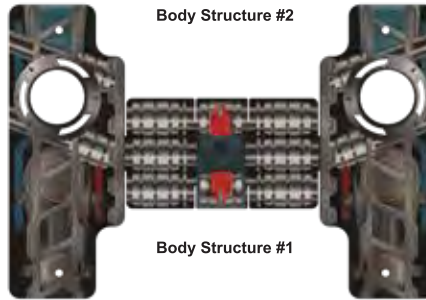

Body Structure #1



Body Cover



Body Cover



Sound Box Cover



Tail



Left Arm



Right Arm



Arm Spacer



Arm Spacer



Neck Cover



Neck Front



Body Bottom Cover

HEAD



Jaw



Bottom Teeth



Top Teeth

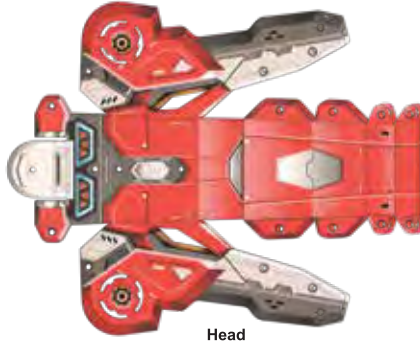

Head



Head Connector #2



Head Connector #1

HINGE & TOOL



Hinge Cap 1
(x6)



White Hinge
(x2)



Blue Hinge
(x4)



Hinge Cap 2
(x6)



Screw
(x106)



Screwdriver

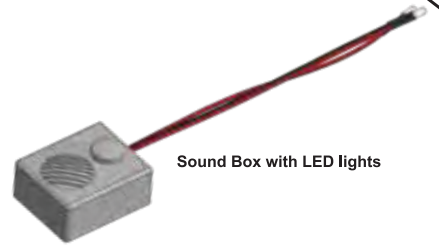

Sound Box with LED lights

BATTERY INSTALLATION

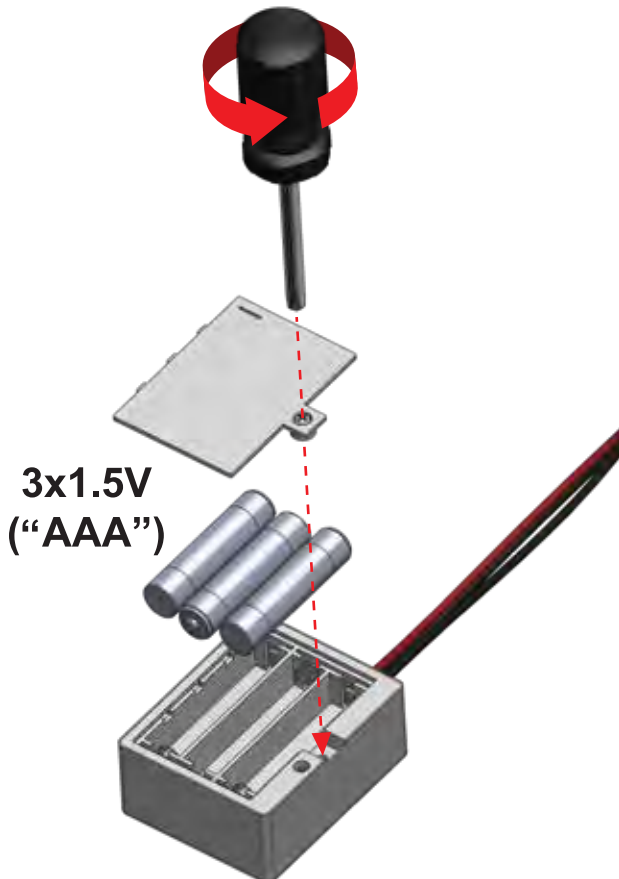

3x1.5V
("AAA")

! Batteries Not Included

SOUND BOX

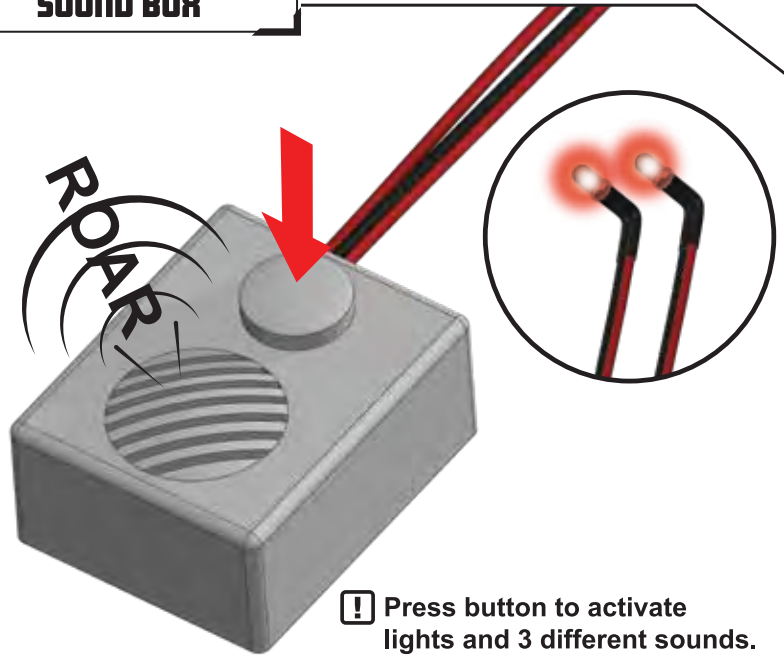

! Press button to activate lights and 3 different sounds.

Do not mix old and new batteries.
Do not mix alkaline, standard (carbon-zinc),
or rechargeable batteries.



CHECK these details before building your T-REX!

HOW TO USE HINGES

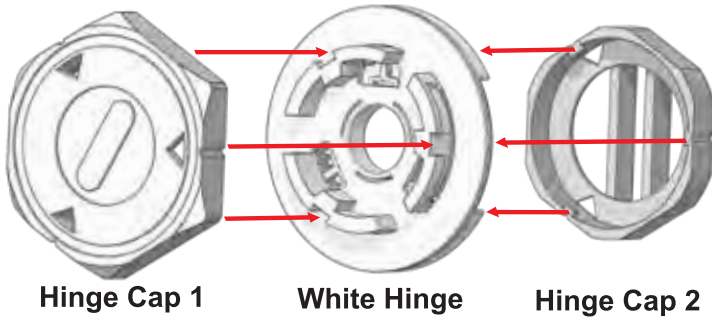

Be sure to check the color of the hinge as outlined in each step.

Blue Hinge

! Check the panel hole shape



Side 1

①

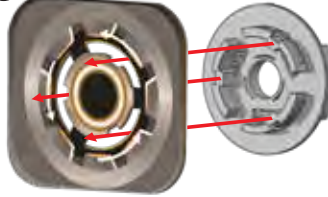

②



③



Hinge Cap 1

! Check the panel hole shape

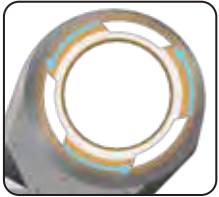

Side 2

①

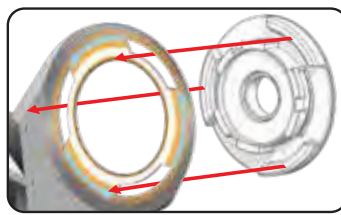

②



③



Hinge Cap 2

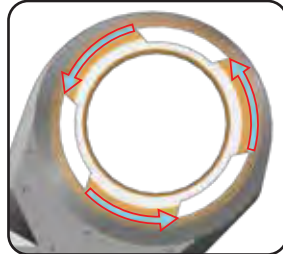

! Follow the arrow graphics on the panel to see which direction to turn the hinge cap.

SCREW ASSEMBLY

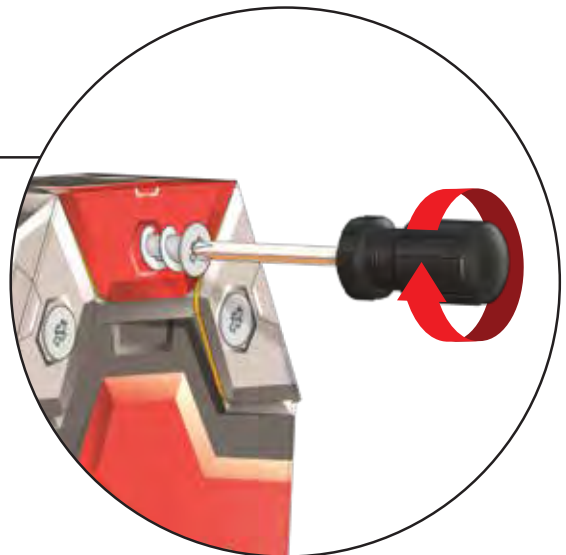
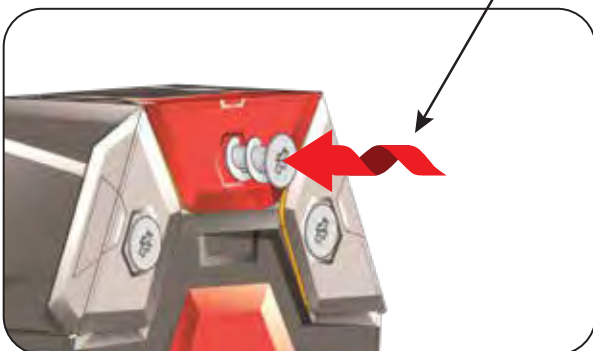

STEP A1



Upper Leg



Hinge Spacer (Leg)



Screw (x5)



White Hinge



Hinge Cap 1

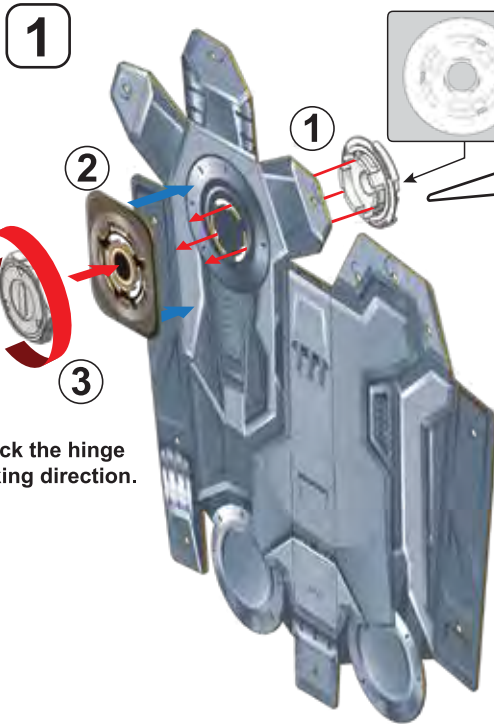

⚠ Check the hinge locking direction.

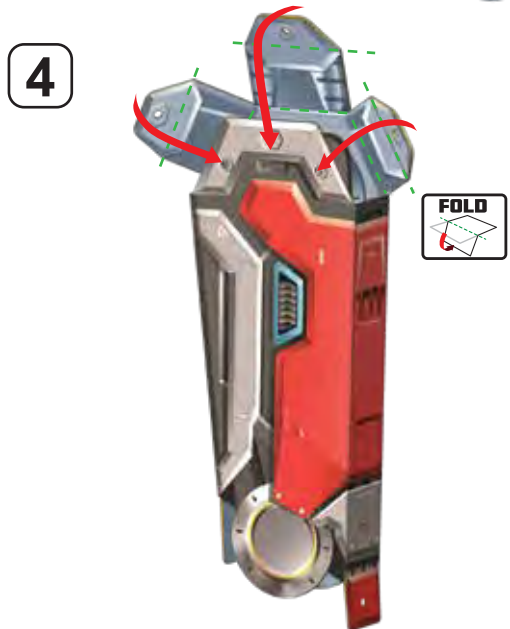
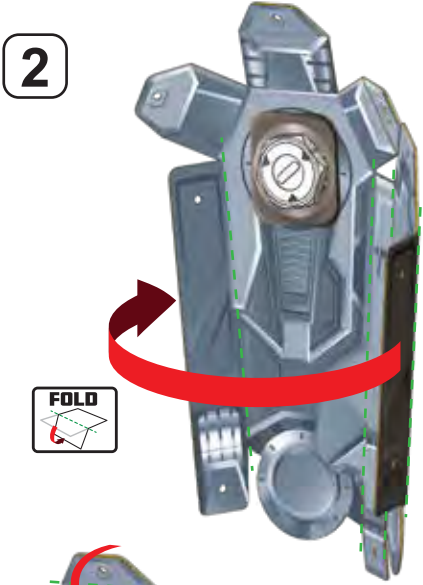
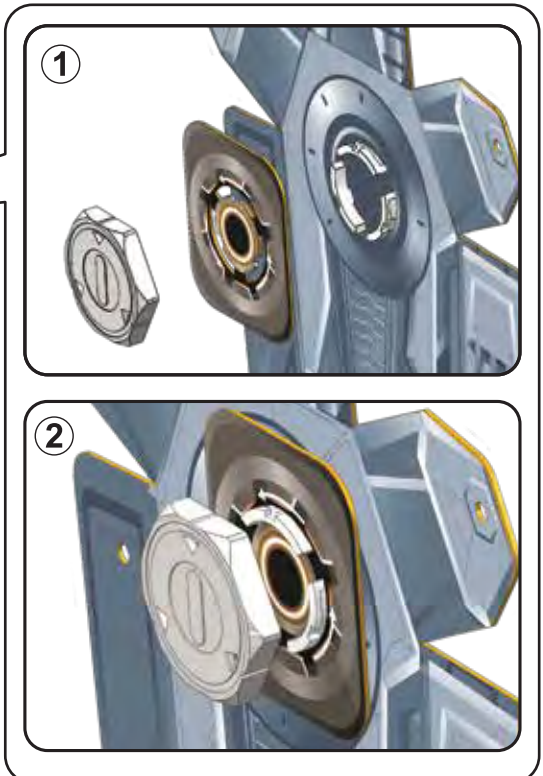

STEP A2

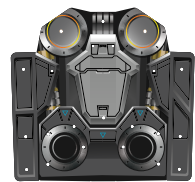

Lower Leg



STEP A3



Foot



STEP A2



Screw (x8)

1



2



3

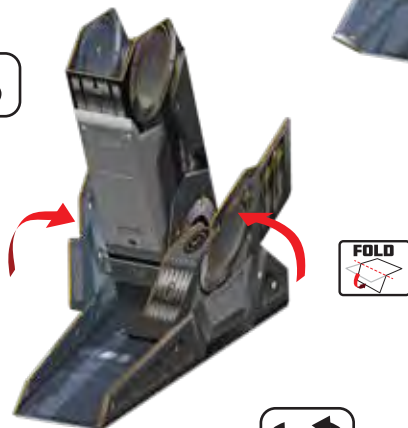

4

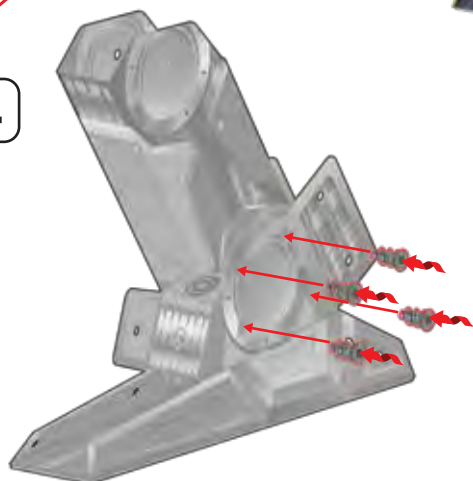

5

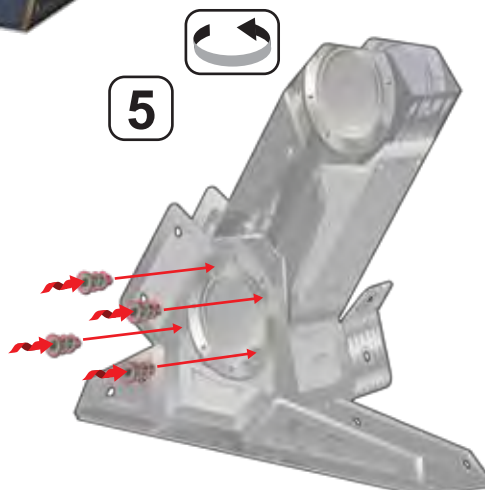

STEP A4



STEP A3



Foot Cover Front



Foot Cover Back



Screw
(x12)

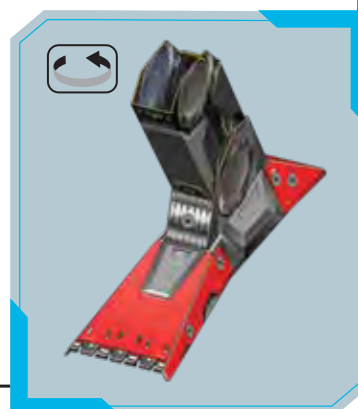
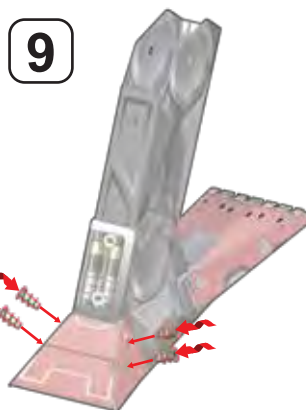
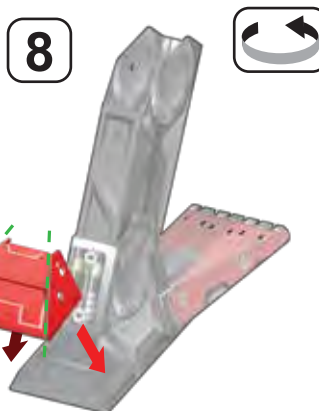
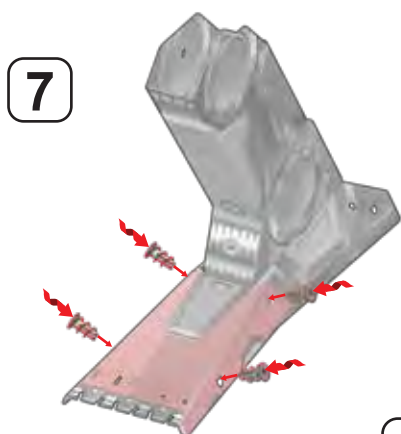
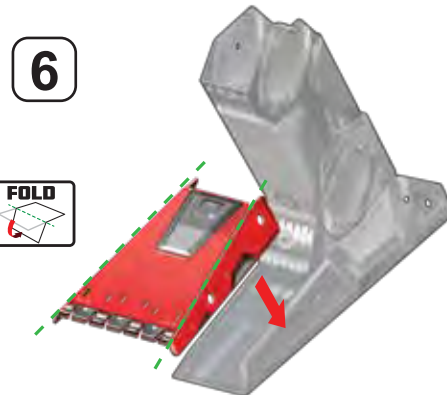
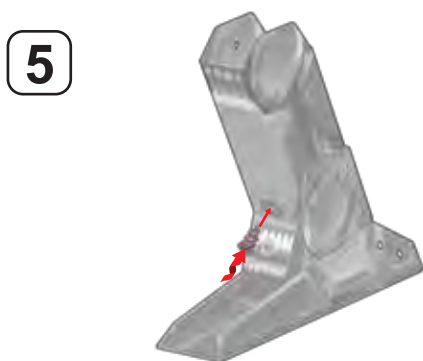
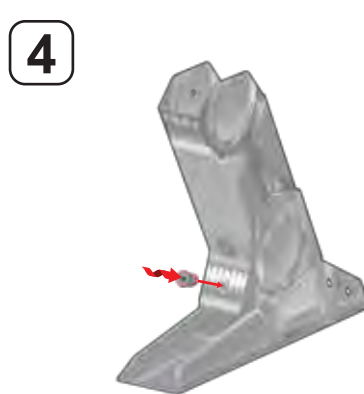
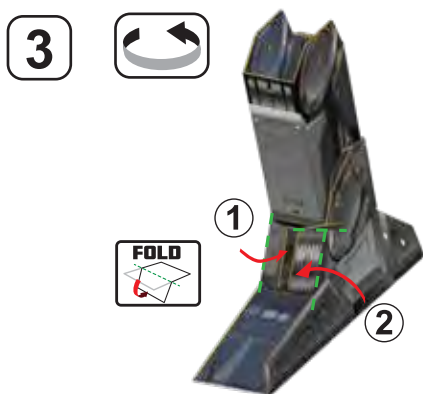
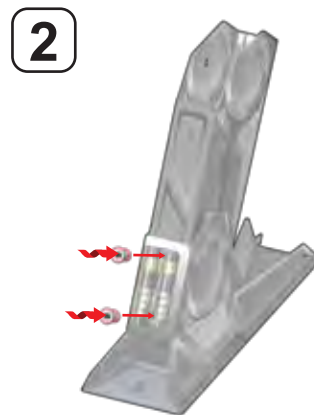
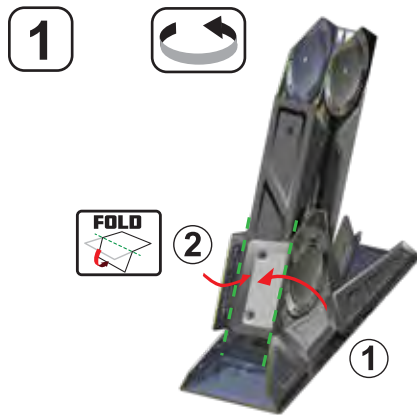

STEP A5



STEP A4



Long Claw



Short Claw (x2)



STEP A1



Screw (x4)

1



Long Claw

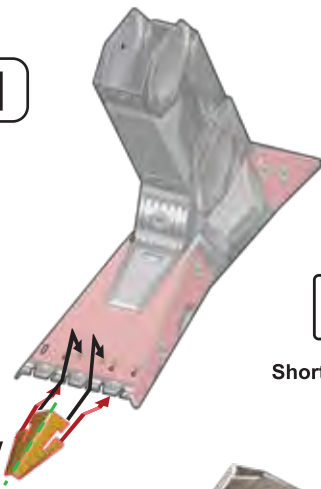

2



Short Claws

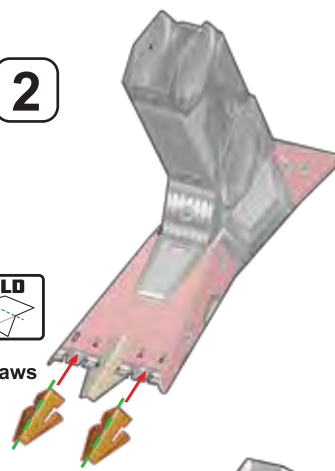

3



4

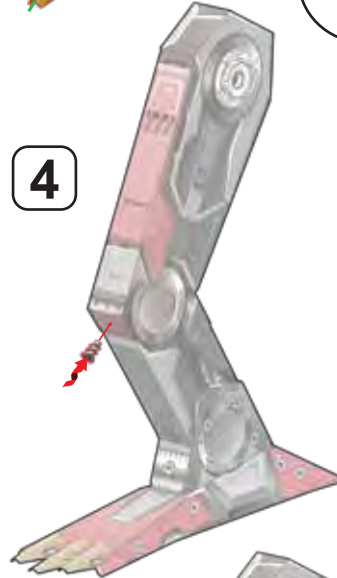

5

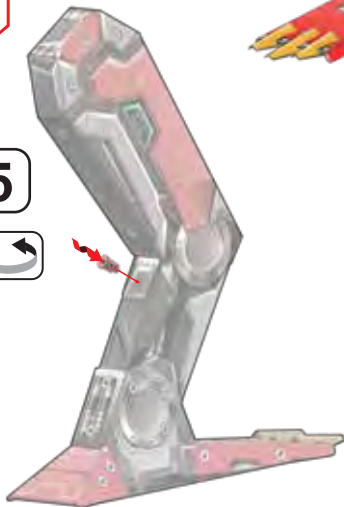

6

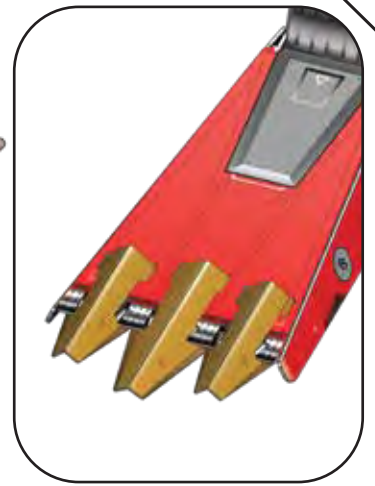
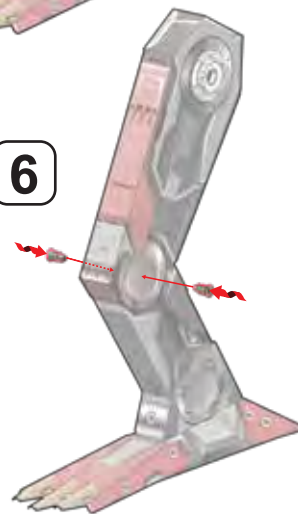

STEP A6

To build the left leg, repeat steps A1 ~ A5 with the left leg parts.

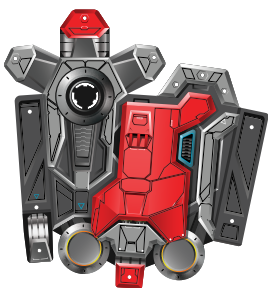

Upper Leg



Hinge Spacer (Leg)

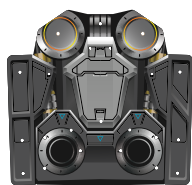

Lower Leg

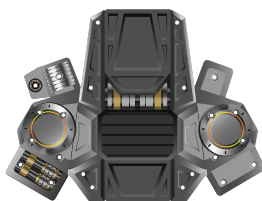

Foot



Short Claw



Long Claw



Short Claw



Foot Cover Front



Foot Cover Back



Screw



Hinge Cap 1



White Hinge



STEP B1



Body Structure #1



Body Structure #2

1

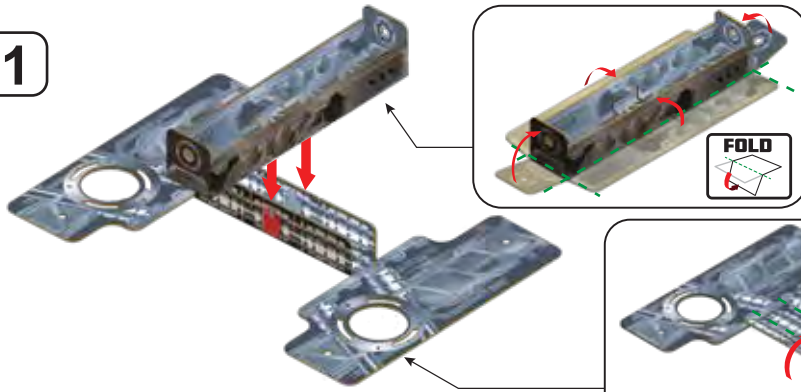

2

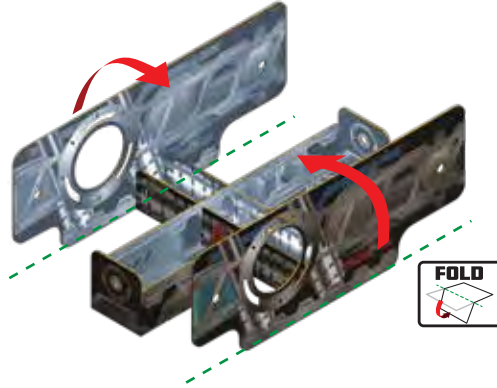

STEP B2



Body Top Cover



STEP B1



Body Cover (x2)



Screw (x8)

1

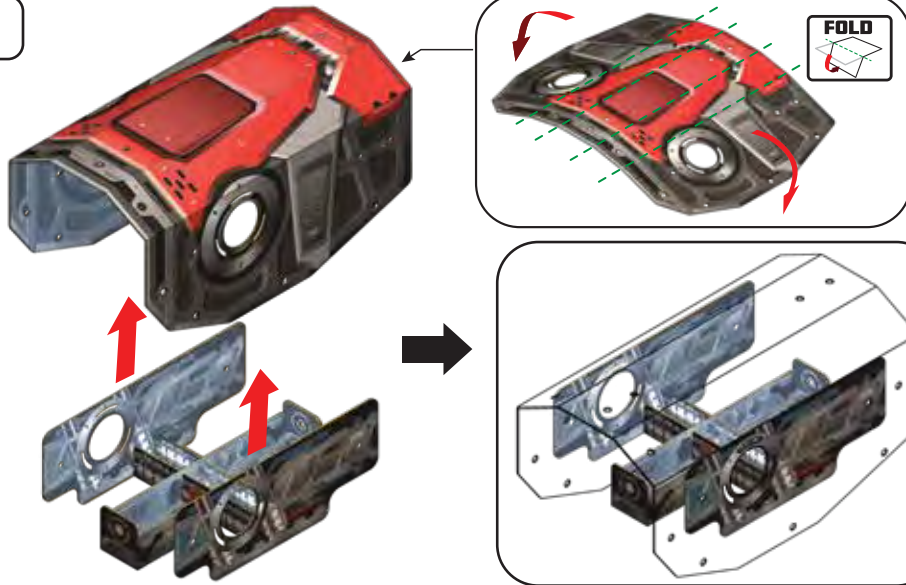

2

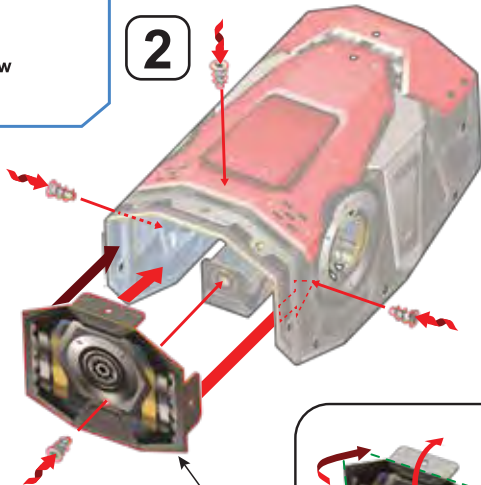

3

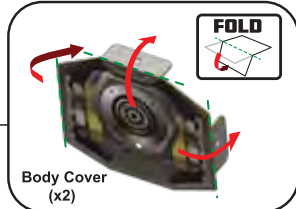
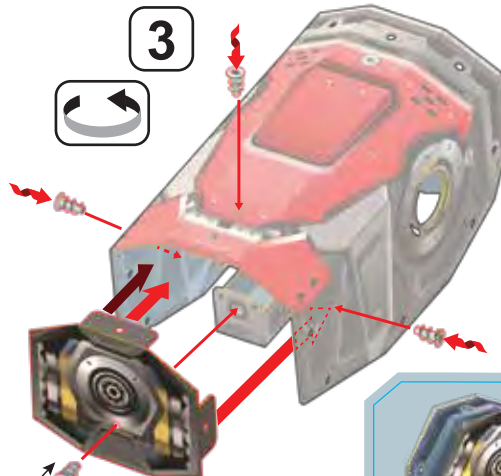

STEP B3



STEP A5



STEP B2



Hinge Cap 2

RIGHT LEG

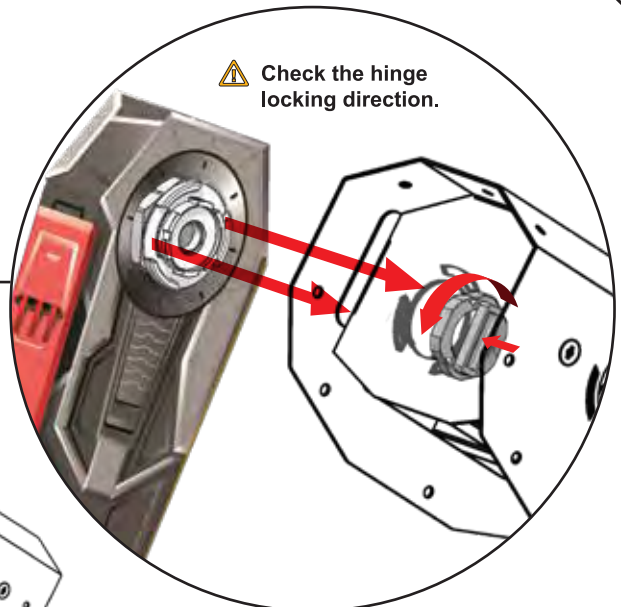

⚠ Check the hinge locking direction.



⚠ Check the body direction.



STEP B4



STEP B3



STEP A6



Hinge Cap 2

LEFT LEG

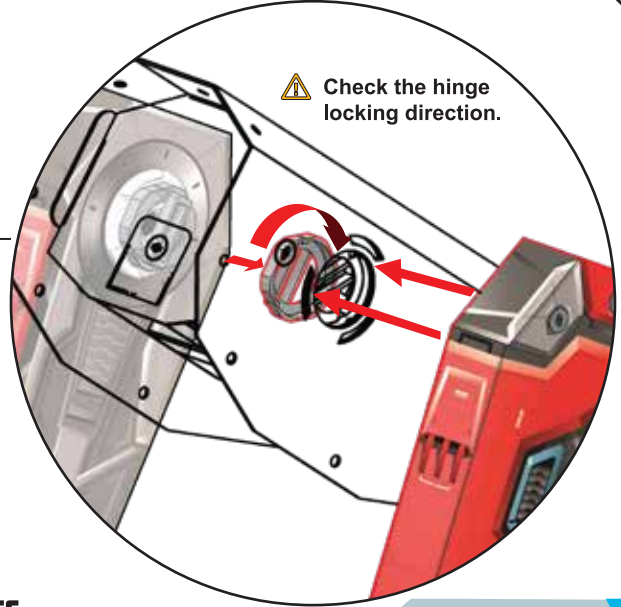
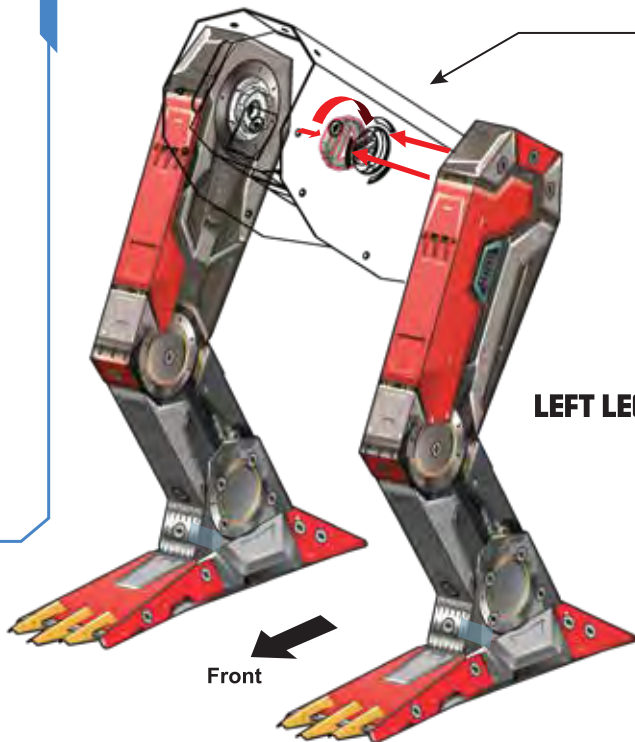

⚠ Check the hinge locking direction.

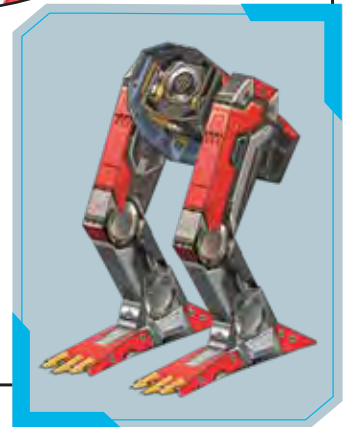

STEP B5



STEP B4



Body Bottom Cover



Screw (x6)

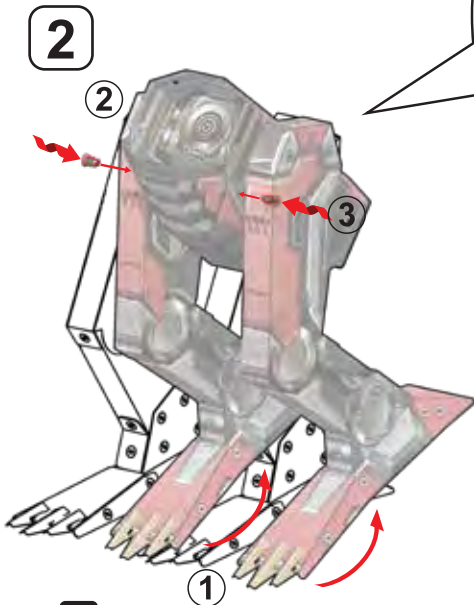
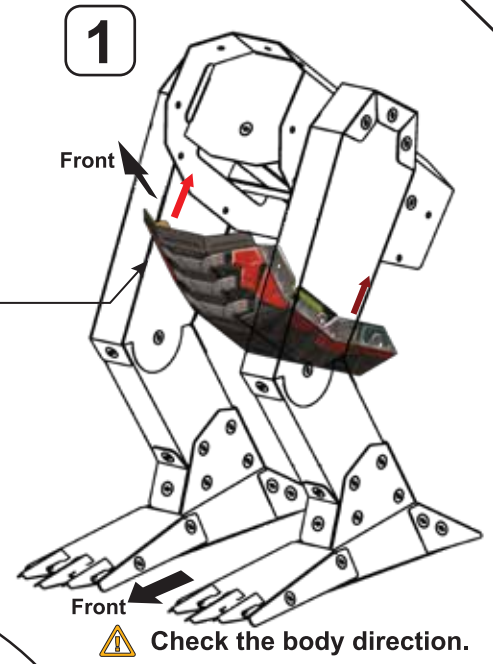
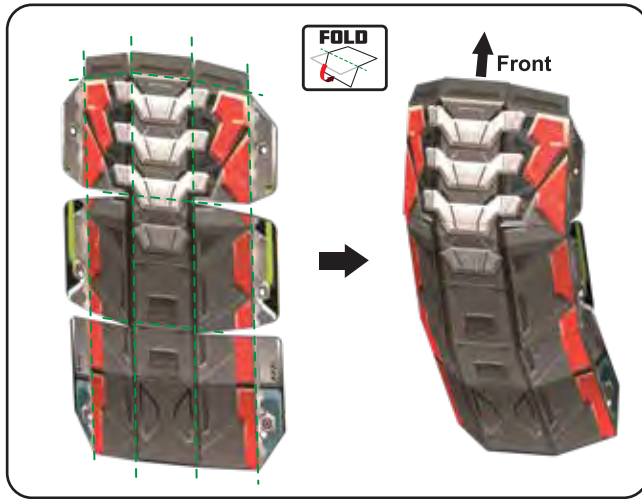

! Rotate the legs to access screw holes.

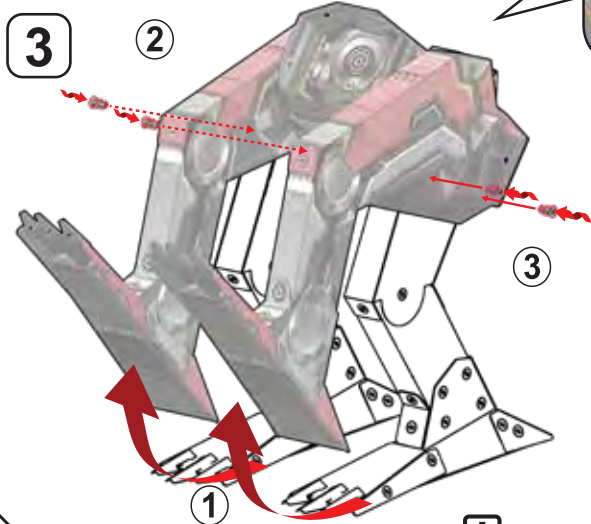
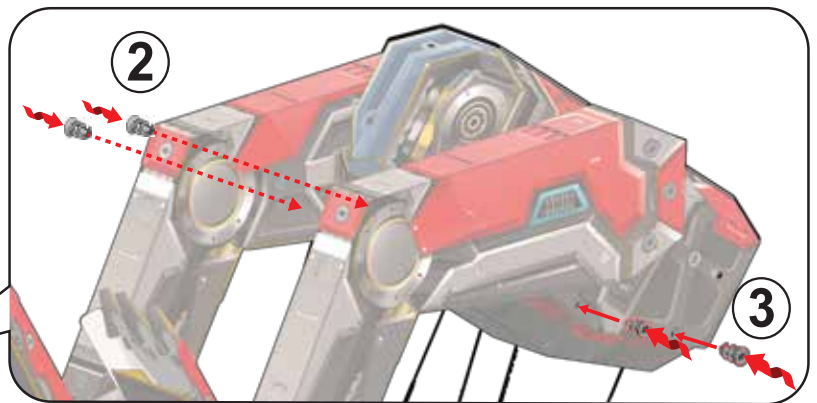
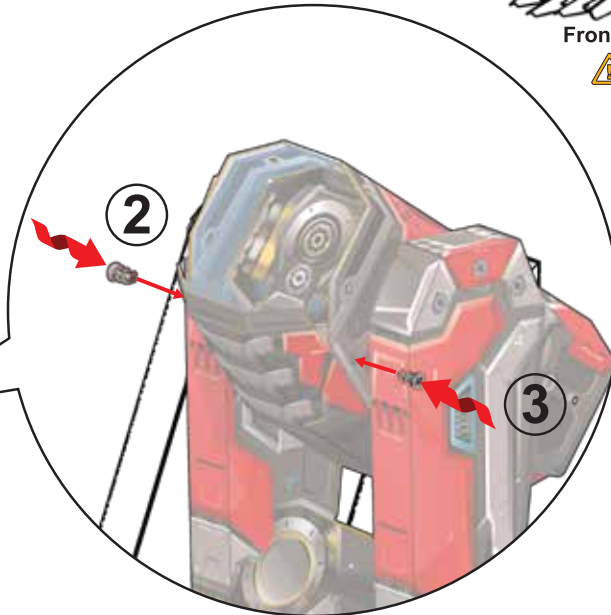

! Rotate the legs to access screw holes.



STEP B6



STEP B5



Tail



Screw (x3)

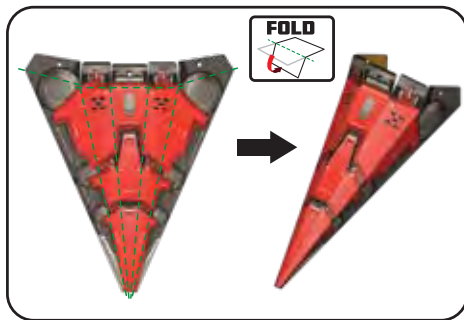

1

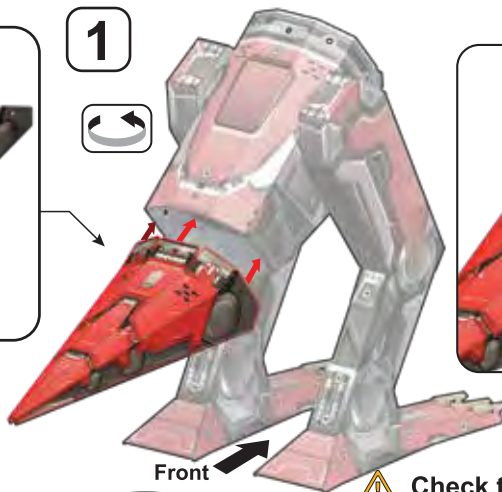

2

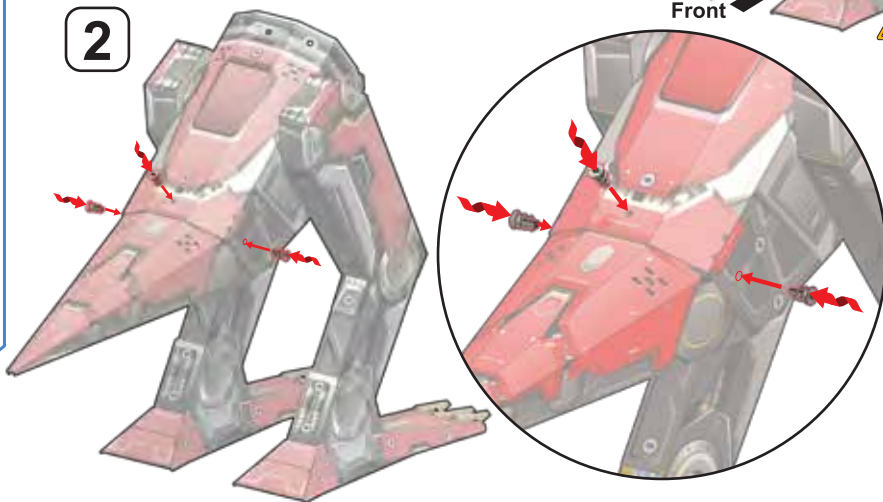

STEP B7



STEP B6



Neck Cover



Screw (x5)

1

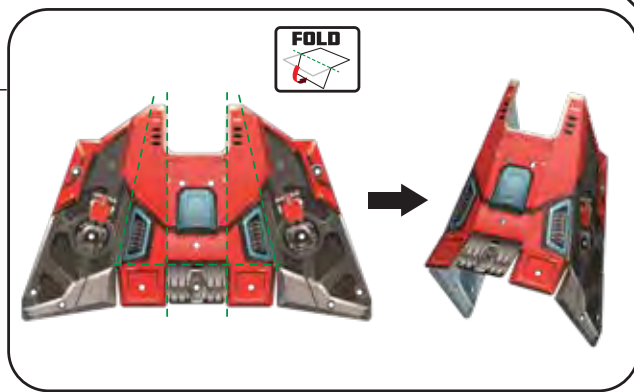

2

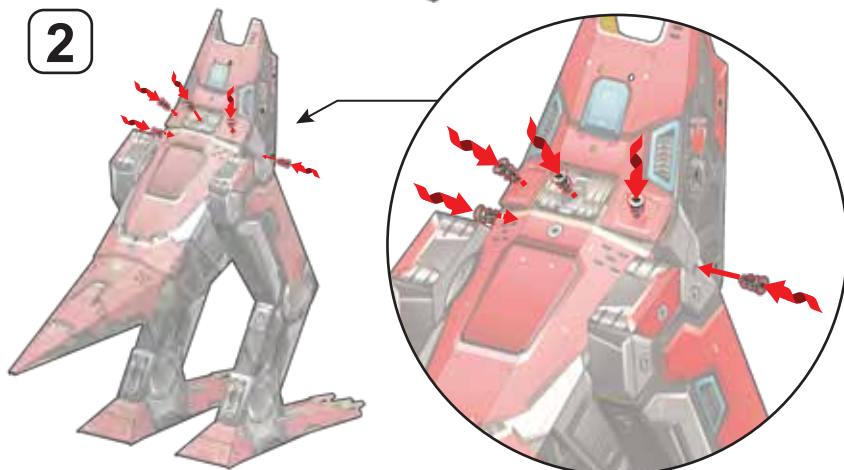

STEP B8

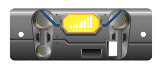

Sound Box Cover



Neck Front



Sound Box



STEP B7



Screw (x6)

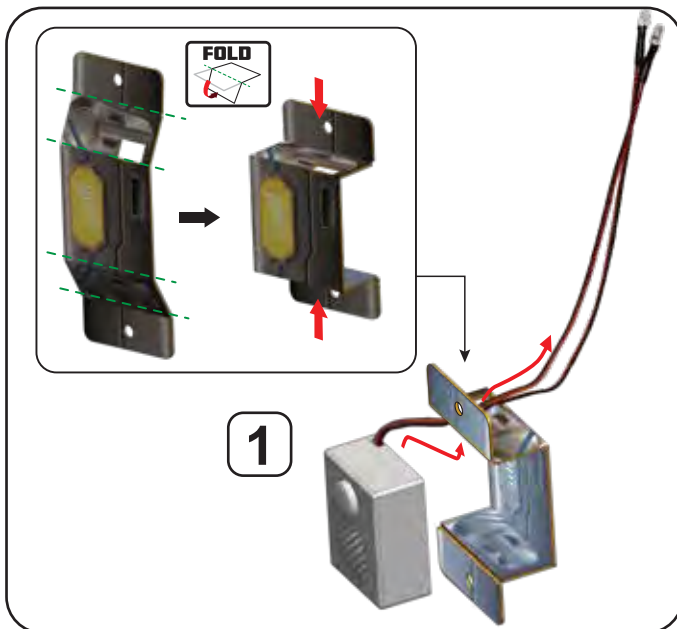

1

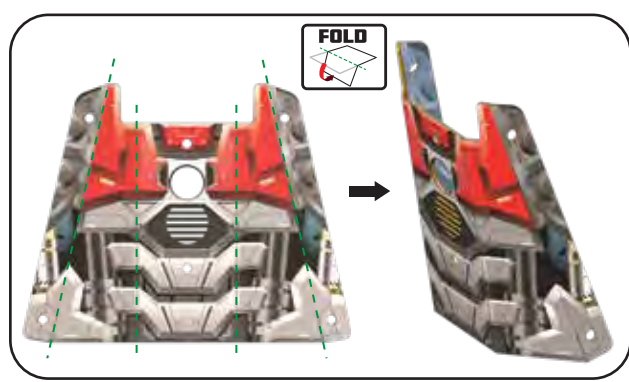

2

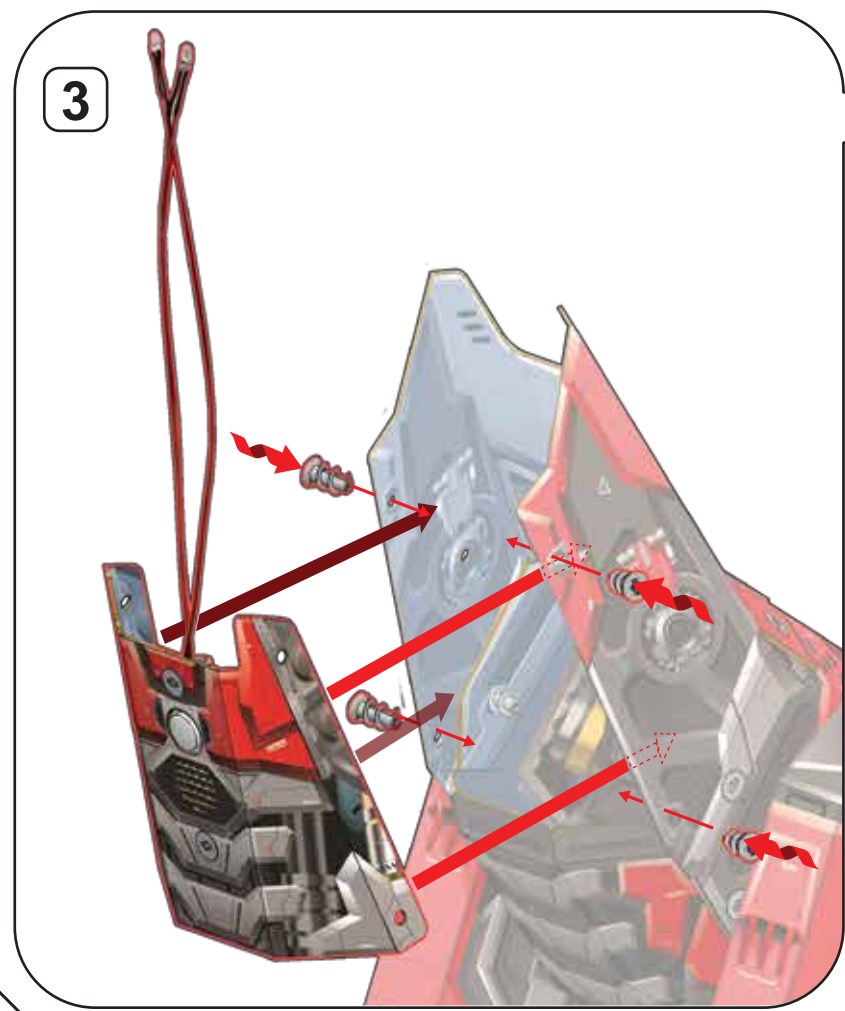

3



STEP C1



Jaw



Bottom Teeth



Screw
(x2)

1



FOLD

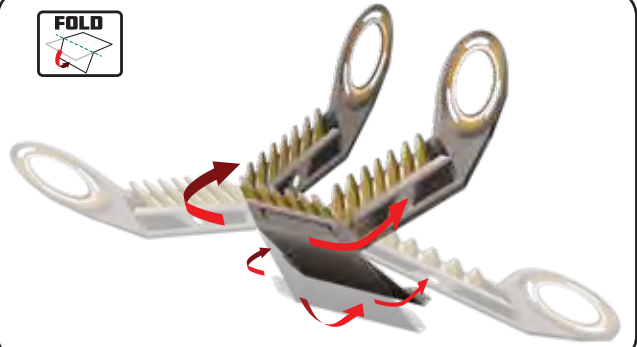

FOLD

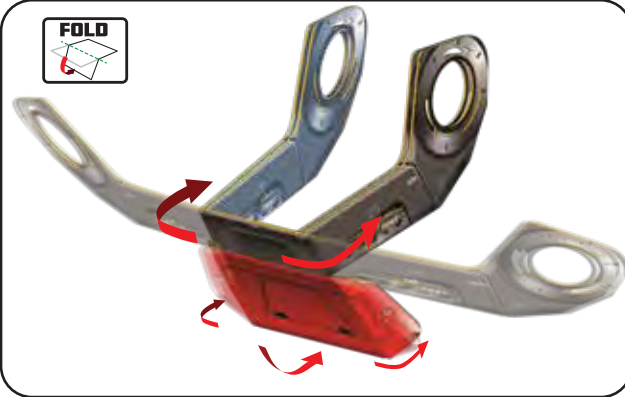

2

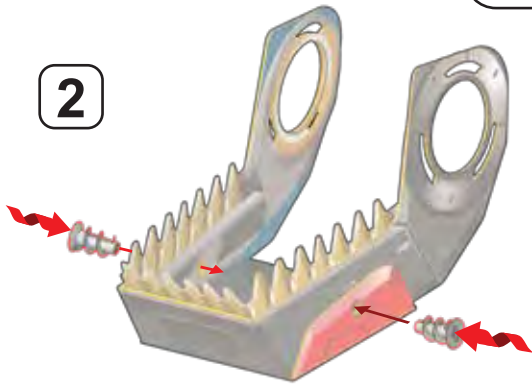

STEP C2



STEP C1



Blue Hinge
(x2)



Hinge Cap 2
(x2)

1

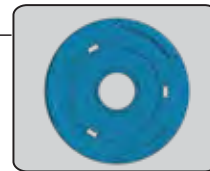
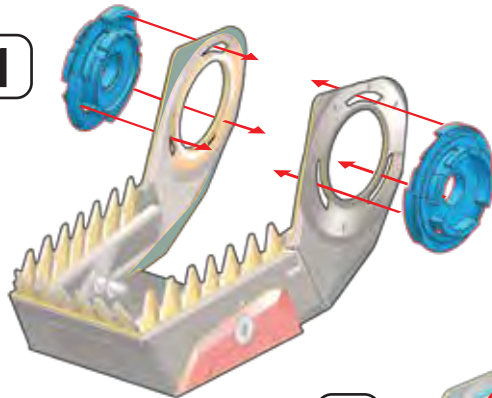

2

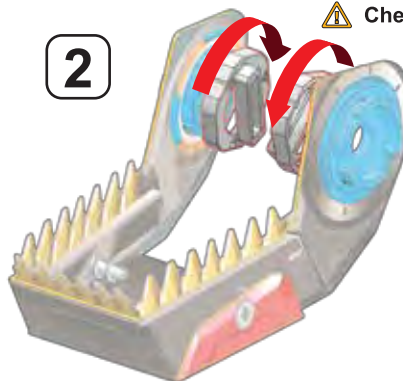

⚠ Check the hinge locking direction.



STEP C3



Head



Top Teeth



Screw (x8)

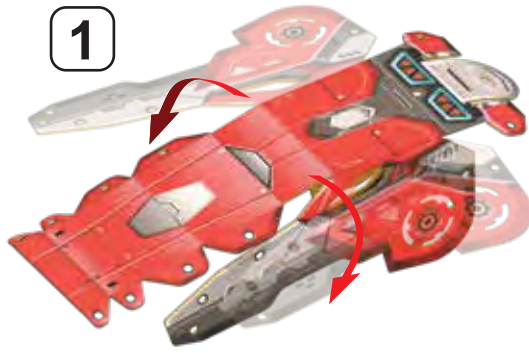

1

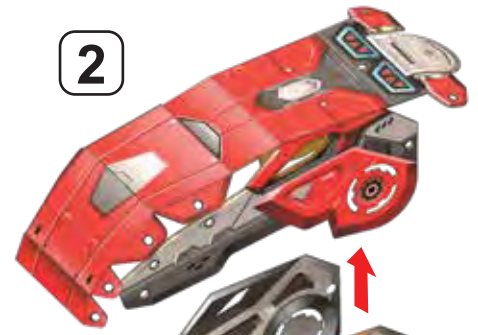

2

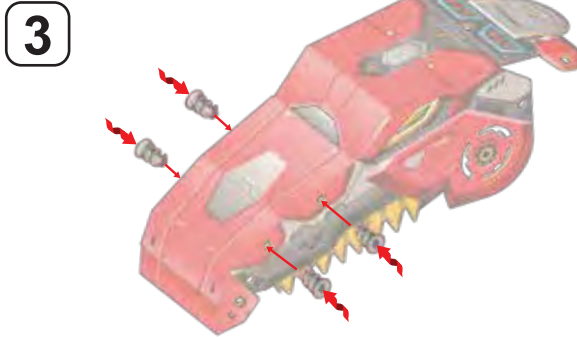

3

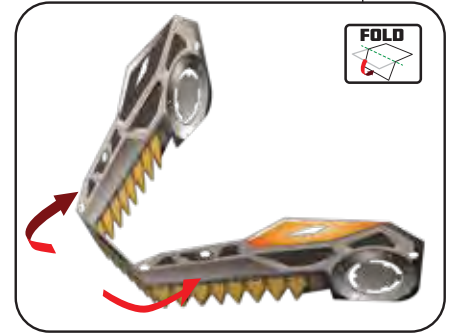

FOLD

4

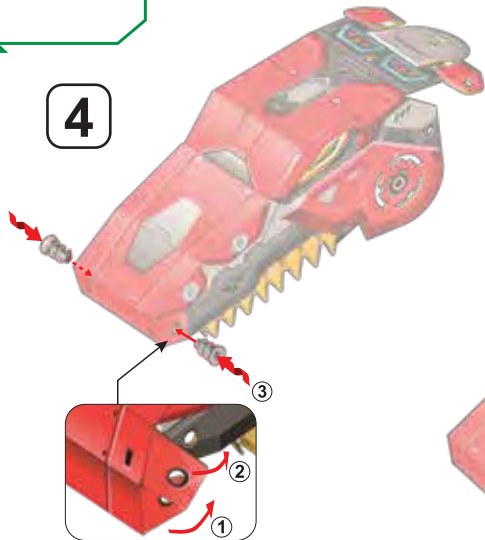

5



1

2

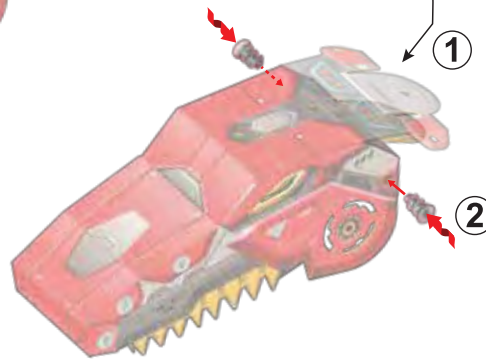

STEP C4



STEP C2



STEP C3



Hinge Cap 1 (x2)

1

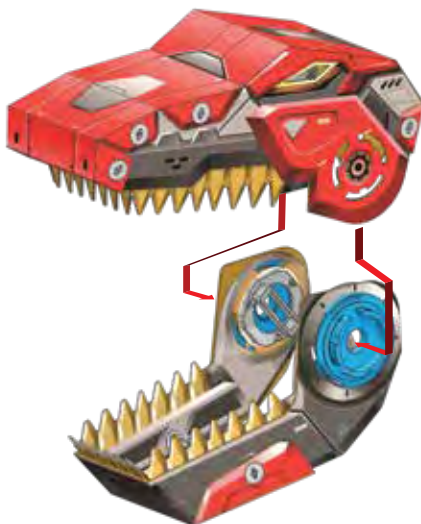

2



⚠ Check the hinge locking direction.



STEP C5



Head Connector #1



Blue Hinge (x2)



Hinge Cap 2 (x2)



Screw

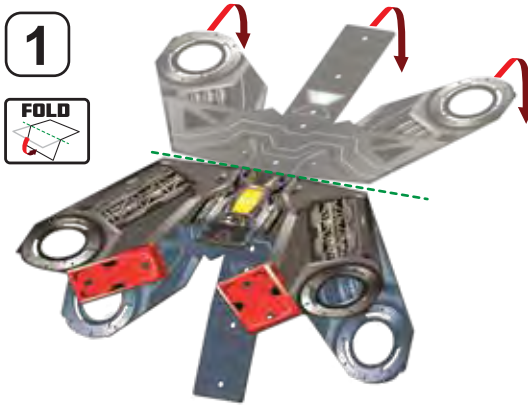

1



2

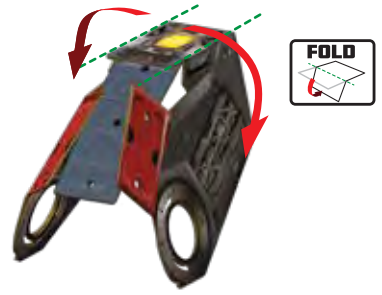

3

⚠ Check the hinge locking direction.

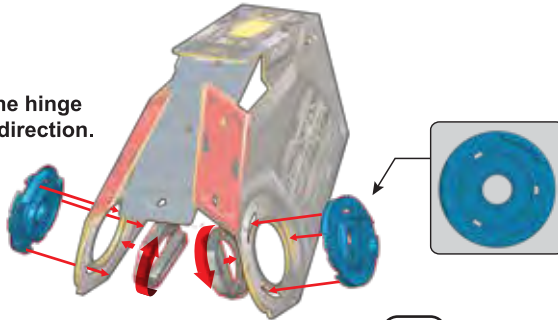

4

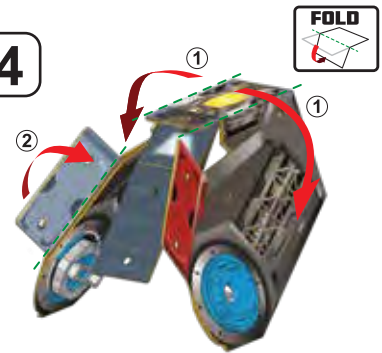

5

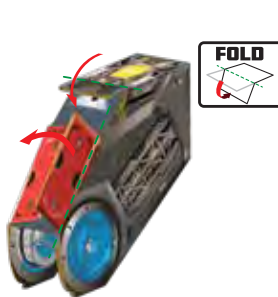

6



STEP C6



STEP C4



STEP C5

Screw (x4)



1

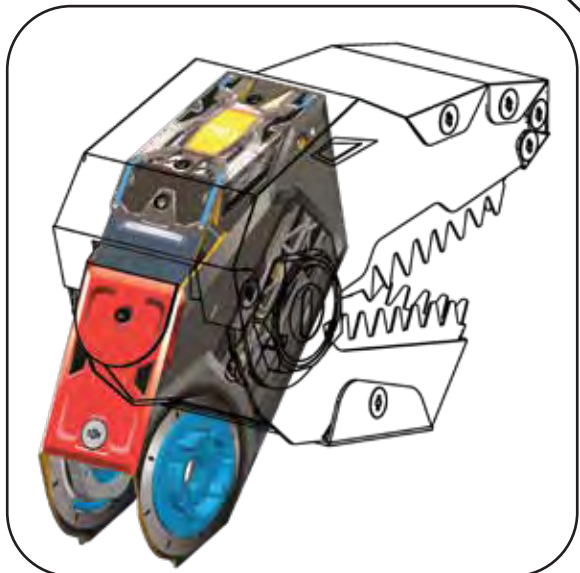

2

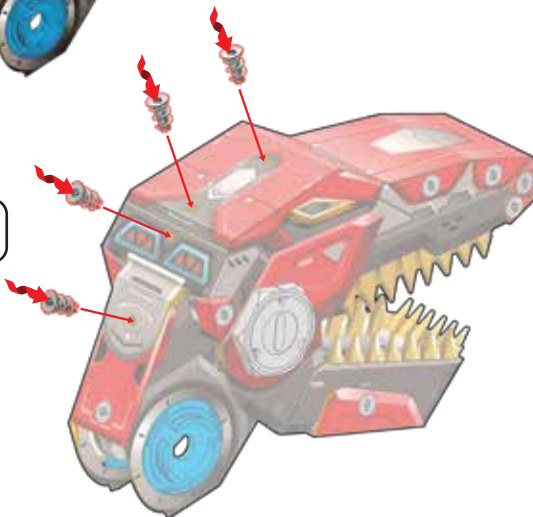

STEP C7



Head Connector #2



STEP C6



Hinge Cap 1 (x2)

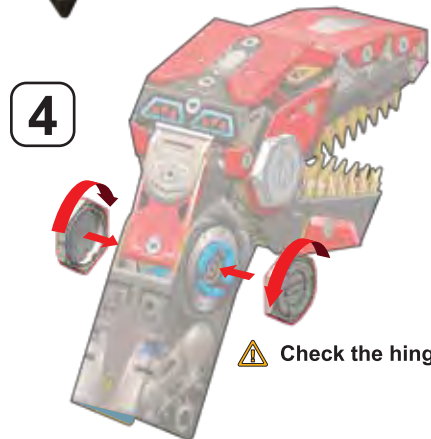
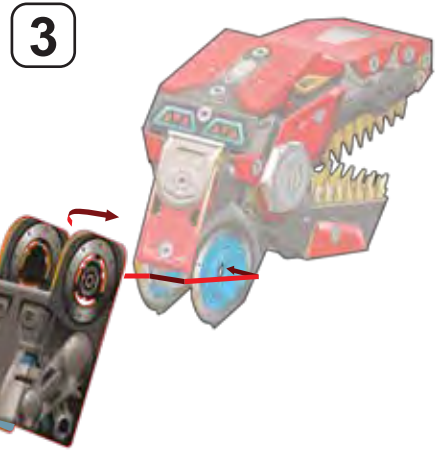
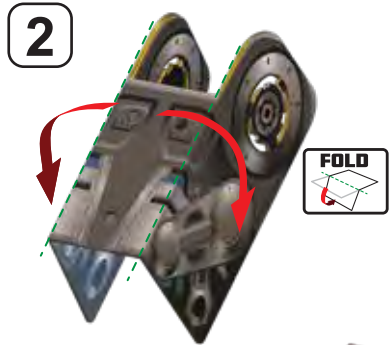
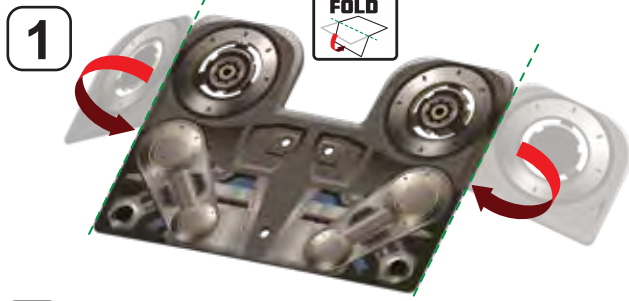

⚠ Check the hinge locking direction.



STEP D1



STEP C7



STEP B8



Screw (x3)

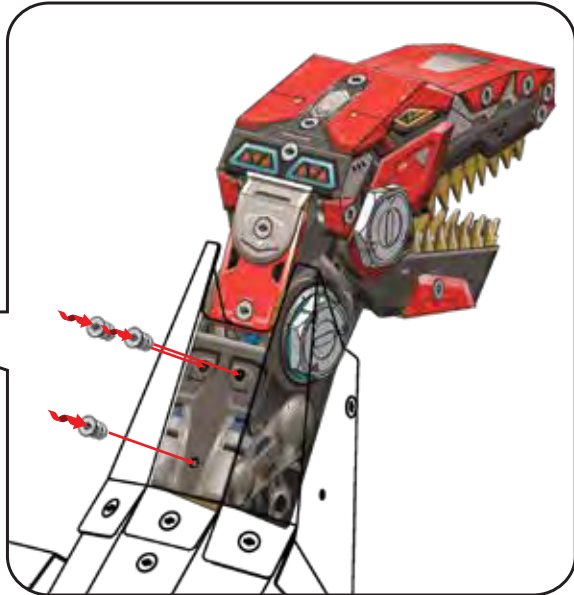

STEP 02

Installing the LED eyes

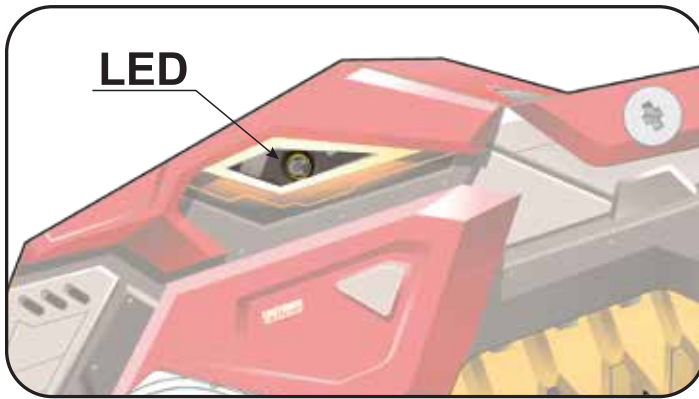

Bend the LED head 90 degrees.

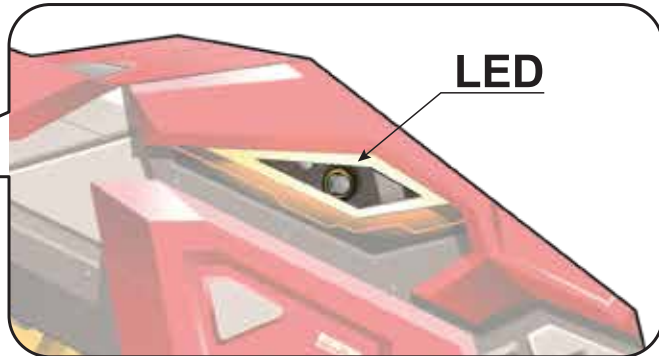
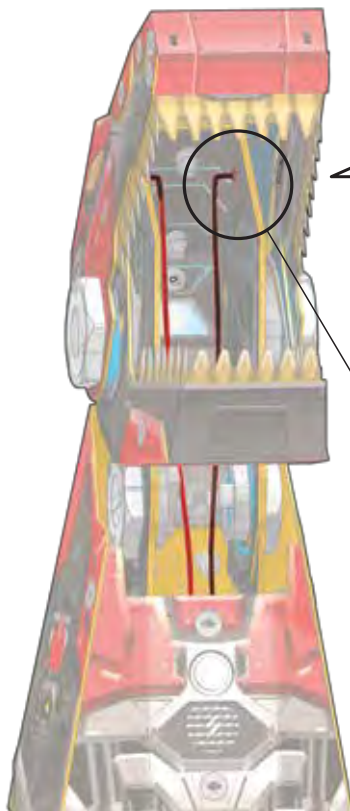
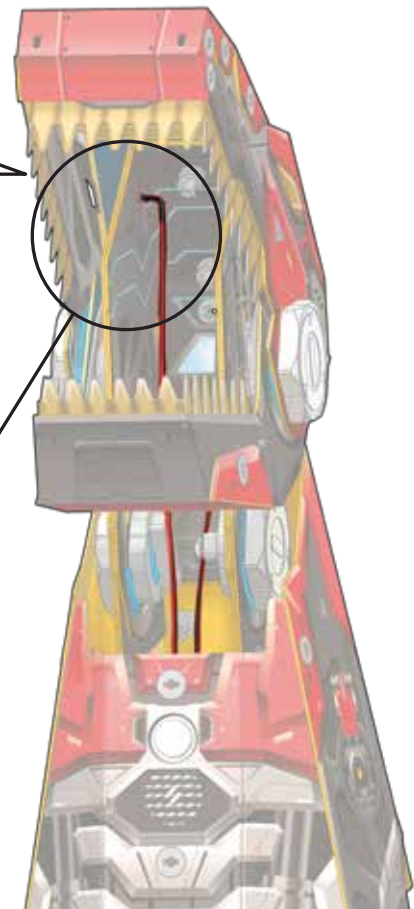
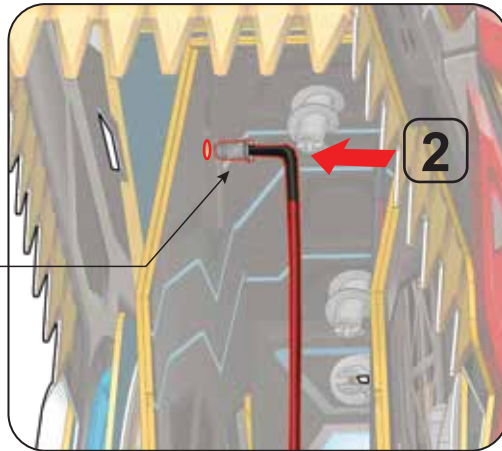
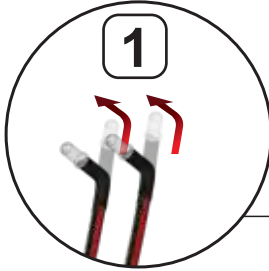

STEP D3



STEP D2



Left Arm



Right Arm



Arm Spacer
(x2)



Screw
(x2)

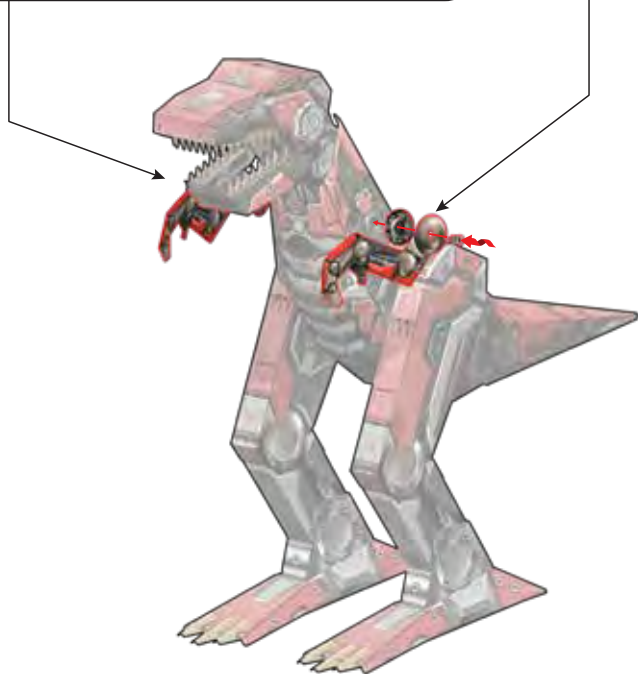
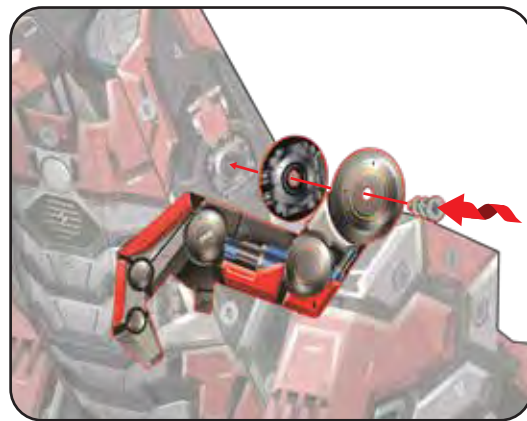
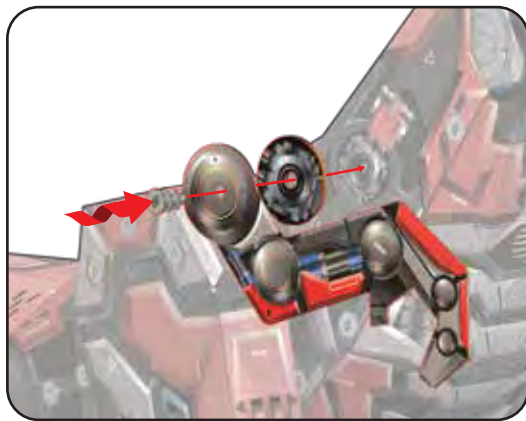

8 POINTS OF ARTICULATION
FOR COOL ACTION POSES!



FEATURES **LIGHT-UP EYES** AND **ROAR SOUNDS!**



(888) 551-4258

customerservice@lukilab.com

www.robomaxbuild.com

Designed in California.
Irvine, CA 92614 USA
Made in China.